

# SOUNDCONTAINMENT



for outstanding  
**home theatre**



# SOUNDCONTAINMENT

Enjoy your movies in peace and quiet

With the right outfitting, your home theatre can be a luxurious space where you, your family and friends can kick back, relax and escape from the everyday routine.



*An afternoon football game can be enjoyed to the full in your home theatre ...*

So you'll probably agree that noise pollution is the last thing you need in your home theatre. Honking car horns and barking dogs can really destroy the mood. As can footsteps thumping across the ceiling from upstairs. Or a flushing toilet in the next room.

Sound spilling out of your home theatre can be just as big a problem. You should be able to enjoy your home theatre whenever you want – not within prescribed hours so that you don't annoy your neighbours. Or only when your children aren't sleeping.



Commercial theatres are carefully sound contained to screen out noise and keep sound within the room. As home theatres become even better than the real thing, a similar solution has become necessary.

After all, what's the point of spending time and money on state-of-the-art audio/visual technology if you can't

enjoy it without disturbing family and neighbours?

And why pay for sensitive sub-woofers and speakers if noise from outside the room is going to drift in and spoil all the quiet spaces in your movie?

CSR Gyprock<sup>®</sup>, along with sister company Bradford<sup>®</sup> Insulation and CSR Hebel<sup>®</sup>, have been managing the acoustics and sound containment in Hoyts and Greater Union Cinemas for several years.

Drawing from this experience, we have developed a unique set of sound containment systems for the home. They're all slim, lightweight and easy to install at a reasonable cost.



*...while other members of the family enjoy an afternoon nap*

# SOUNDCONTAINMENT

## Sound containment without disruption

**Whether you are building your home from scratch, creating an extension to your home, or converting an existing room, a CSR sound containment package to suit your specific needs can be installed without mess or fuss.**



You can also avoid wasting time and money dealing with separate noise pollution problems as they become apparent. CSR sound containment packages make it easy to address all of your home theatre's sound containment issues at once.

So you will have a home theatre that you can use whenever you want, without disturbing anyone.

## Don't fall foul of the law

**CSR sound containment packages will help you to comply with noise laws.**

4 These laws vary between states and territories, but the general rule is that audio equipment should not produce more than five decibels above the background noise level in your neighbourhood. Our sound containment packages will keep your home theatre well under this level.

Building regulations also vary according to state, territory and local council laws. CSR or your CEDIA member will be able to help you to comply with these. Issues to be aware of in your home theatre include smoke alarms and ventilation in rooms without windows.

## The sound choice is CSR

**CSR Gyprock, Bradford Insulation and CSR Hebel have a commitment to producing high-performance acoustic and building materials. Our names have been synonymous with excellence in walls, ceilings, floors and insulation for more than half a century.**

We are also experts at creating comfortable and aesthetic environments for the enjoyment of movies. That's why we manage the acoustics and sound containment for Australia's top commercial cinemas.

Our goal for the home theatre market was to produce lightweight, reasonably priced sound containment options that take up minimal space. We have developed the most comprehensive range of sound containment systems in Australia.

### CSR guarantees all its products

**All of the CSR companies offer their customers a guarantee with their products so you can be sure to feel certain that the system you have installed can be relied upon.**

**CSR**  
**Gyprock**  
Everything else is just plasterboard

**CSR**  
**Bradford Insulation**

**CSR**  
**Hebel**  
for future living  
lightweight wall & floor systems

# SOUND CONTAINMENT OPTIONS FOR EVERY WALL TYPE

Here's an example of the construction of one of our nine systems; this one is designed for a new building with a single stud wall – System HT1.

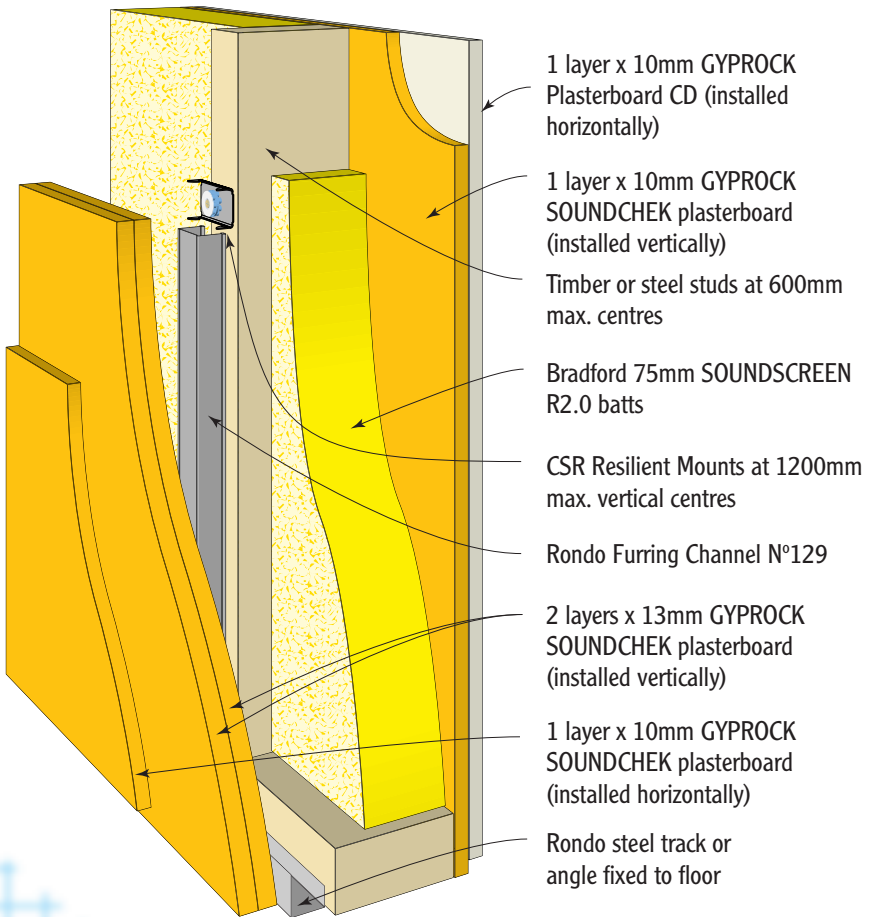

# Choose the right sound containment for your home

## CSR sound containment systems work with most internal and external walls, whether they are masonry, single, or double stud walls.

Check with your builder to identify the types of wall you have in your home theatre room. CSR and your CEDIA member will be able to help you identify the right package for your needs. For more information, refer to the CSR sound containment packages technical manual (available from CSR and your CEDIA member).

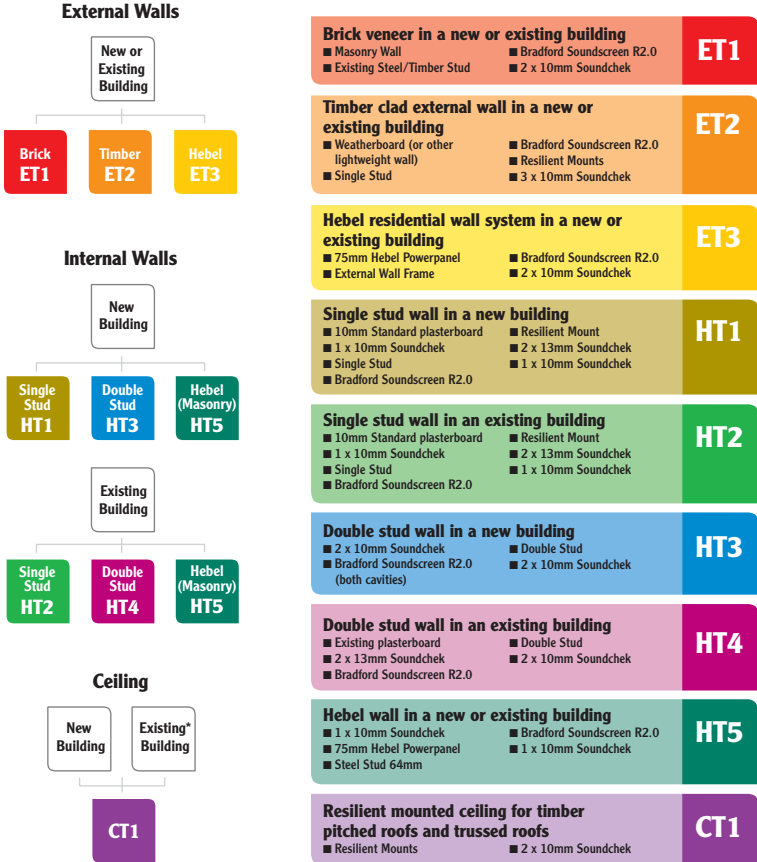

# SOUNDCONTAINMENT

**CSR sound containment packages are put together according to your needs. By combining the following products as recommended, we guarantee a dramatic reduction in sound transfer – creating the perfect quiet area to enjoy your home theatre.**

**CSR Gyprock Soundchek** is Australia's first acoustic plasterboard, designed to reduce the transfer of unwanted noises through walls and ceilings. Soundchek's lightweight design means it is easily attached to single or double-stud walls or masonry walls. Panels are only 10mm – 13mm in thickness, so they take up minimal space. Super high-density construction enables Soundchek to cut down on noise between rooms by between 50% and 75%. CSR Gyprock Resilient Mounts can be teamed with Soundchek to further decrease noise transmission.



**CSR Bradford SoundScreen Insulation** is made from acoustically optimised rockwool and can be installed between walls, under floors and into ceilings to dampen sound transfer.



**CSR Hebel** wall and floor solutions are made from an environmentally friendly, lightweight masonry called Autoclaved Aerated Concrete (AAC). CSR Hebel provides all the benefits of concrete such as strength, versatility, pest and fire resistance. The special cellular structure gives the material remarkable sound containment properties, as well as making it light, quick and easy to install. CSR Hebel is available in a range of blocks, steel reinforced panels to suit your requirements.



## Finishing touches

### Other ways to make your experience more enjoyable.

After you've treated your walls, consider these ideas to get the best results.

- Fit solid core doors.
- Avoid recessed light fittings and back-to-back power points and light switches. (These tend to defeat sound containment and transfer noise.)
- There are many alternatives to recessed lighting. You may want to create a soft ambient lighting effect during your movie. Installing a night light near the door will allow people to enter and leave without disrupting the film.
- Team double-glazed windows with thick fabric curtains to absorb light as well as sound.
- Seal any gaps and junctions between walls, floors, doors, windows and vents with an acoustic filler such as FireMastic.
- Use upholstered furniture and other soft furnishings to help absorb sound within the room.
- Cover flooring with rugs or a carpet. Thick wool carpets over a felt underlay are much more effective at absorbing sound than thin or synthetic carpets.
- Some form of mechanical ventilation may be required to improve airflow. CSR recommends fitting your home theatre with at least one fan-assisted inlet vent and one exhaust vent.
- Use Ecophon Focus F ceiling panels to further increase sound absorption.
- Hebel SoundFloor™ can provide thermal and noise reduction properties in a light weight concrete floor.

Your CEDIA member or CSR can help you decide on the necessary finishing touches for your home theatre. They can also recommend other ways to reduce echo and improve sound acoustics within your home theatre space.

# SOUNDCONTAINMENT

---

## Quiet please!

**With the right sound containment in place, you'll have a quiet area that you and your family and friends can enjoy for years. With a little effort, a home theatre can be much better than the real thing – especially when you have it set up according to your personal tastes, with seating and lighting arranged perfectly for every member of the family.**



*Family enjoying their new sound contained home theatre*



Install your own popcorn machine or build a ‘candy bar’ (or any other kind of bar!) to add to the fun. You can even programme your lights to slowly dim as your movie starts – a great way to add to the atmosphere and build excitement.

Once you have your own home theatre you’ll be hard pressed to imagine fighting crowds, standing in queues, sharing armrests and tolerating chatter from other patrons in a commercial cinema.

Enjoy your movies in comfort – and in peace and quiet.

Talk to your CEDIA member or CSR for more information on sound containment your hometheatre.



For more information on all products call:

Ph: 1300 306 556

Fax: 9949 9282

[www.csr.com.au](http://www.csr.com.au)



[www.cedia.com.au](http://www.cedia.com.au)

### **About CEDIA**

The Custom Electronic Design & Installation Association (CEDIA) is a global trade organisation of specialist suppliers, manufacturers, custom designers, distributors and installers of electronic systems for the home.

CEDIA brings together the most advanced technology and expertise available. CEDIA members are licensed, insured professionals who work directly with home-owners and their architects, builders and interior designers.

All CEDIA members adhere to a strict code of practice that defines clear principles of professional conduct and ethics in the field of custom installation.